

UNIQUE TYRE TYPE AUTOMATIC FLEXIBLE CUSHION COUPLINGS-TC SERIES

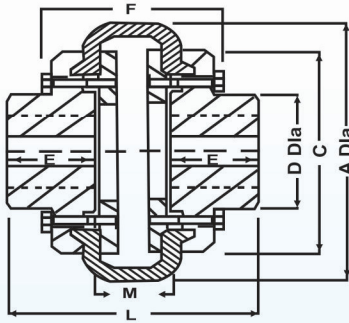

UPTO SIZE TC/M/017

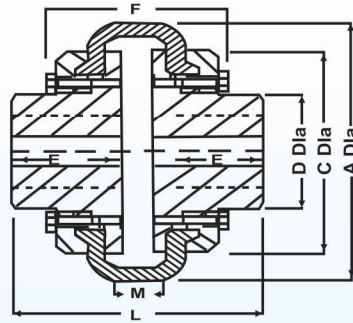

SIZE TC/L/018 AND LARGER



Size	Max Bore mm	Max Speed RPM	Cont. Rating		Max Torqu NM	Appx Dimensions					Torsional Stittness NM/rad	Appx Weight (Kg.)
			Torque Nm	HP / 100 rpm		A Dia mm	L mm	D Dia. mm	E mm	M mm		
TC/Z/001	9	6000		Nominal		42	54	27	19	16	60	0.2
TC/Z/002	11	6000		Nominal		54	68	38	24	20	150	0.5
TC/Z/003	14	6000		Nominal		70	78	43	27	24	220	0.7
TC/Z/004	18	6000		Nominal		93	74	30	26	22	415	0.9
TC/Y/005	22	5500	6	0.08	18	97	74	35	25	24	520	1.3
TC/X/006	24	5500	12	0.17	36	105	84	38	32	20	630	1.6
TC/W/007	28	5500	18	0.25	54	105	111	43	40	31	1000	1.7
TC/V/008	32	5500	24	0.34	72	120	95	51	37	21	1455	2.7
TC/U/009	38	5500	36	0.50	108	135	108	58	39	30	1890	3.4
TC/US/0095	42	5500	46	0.65	138	144	120	66	48	24	2400	5.2
TC/T/010	45	4400	54	0.75	162	160	132	71	49	34	2600	6.4
TC/S/011	48	4300	64	0.90	192	164	133	75	51	31	3200	7.7
TC/R/012	45	4200	84	1.18	282	176	147	71	53	41	4000	7.4
TC/Q/013	51	3750	132	1.85	396	188	145	80	53	39	4300	10.0
TC/P/014	62	3200	200	2.8	600	212	155	95	56	43	6200	12.0
TC/O/015	76	2750	265	3.7	795	240	173	118	62	49	8900	19.0
TC/N/016	90	2700	355	5.0	1065	270	181	140	68	45	9900	27.0
TC/M/017	95	2600	565	7.9	1695	280	215	145	76	61	13400	32.0
TC/L/018	100	2550	720	10.1	2160	310	195	154	90	15	14200	42.0
TC/K/019	105	2500	940	13.2	2820	316	202	159	96	10	35000	48.0
TC/J/020	130	2200	1440	20.2	4320	370	225	203	110	6	47600	79.0
TC/I/021	130	2000	1795	25.2	5365	370	240	203	115	10	66000	85.0
TC/H/022	150	1700	2870	40.3	8610	412	256	237	118	20	110000	115.0
TC/G/023	150	1600	4445	62.4	13335	448	280	230	125	30	188000	127.0
TC/F/024	200	1300	6425	90.2	19275	530	282	315	128	26	200000	218.0
TC/E/025	165	1250	8215	115.3	24645	546	365	280	147	71	310000	224.0

The UNIQUE Tyre Coupling is torsion ally soft flexible coupling, a feature that is most desirable for optimum torque transmission. Being flexible, it has inherent qualities of absorbing misalignments that occur in drive systems.