



# UNIQUE COUPLINGS INDIA

## ISO 9001: 2008

### UNIQUE DOUBLE DIAPHRAGM COUPLING

#### Unique Double Diaphragm Coupling

##### Series 1750

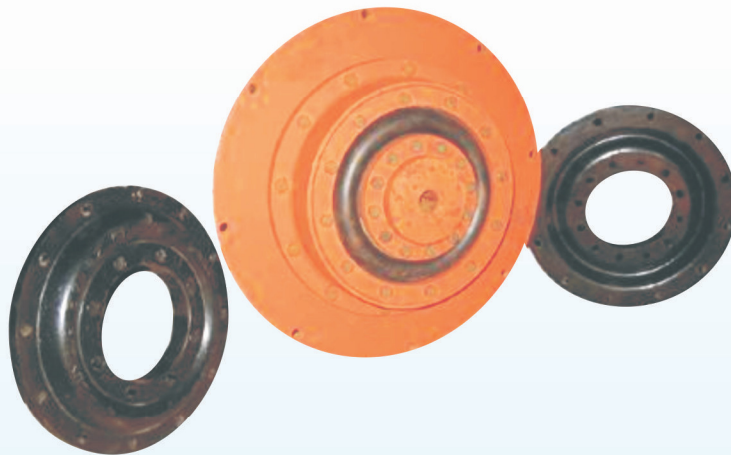
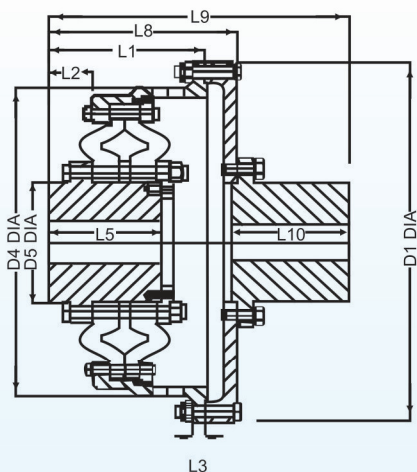

Size VEZ	Max Speed		Dimensuins										DO Max		DS max mm	N	D7	Weight Kg
	CI RPM	CS RPM	L1	L2	L3	L5	L8	L9	L10	D1	D2	D3	CI	Steel				
356,40S	4600	6700	71	16	8	52	104	157	56	221	205	189	35	35	52	12	10	11.6
43S,45S	4000	5870	83	21	8	62	117	176	62	252	235	218	45	50	58	12	10	16
51S,55S	3400	5500	92	23	10	69	128	196	71	290	268	246	50	55	70	12	11	22.8
60S	3400	5100	92	23	10	69	128	196	71	290	268	246	60	65	70	12	11	23.8
61S,65S	2850	4480	106	26	12	80	157	243	90	330	304	276	60	65	80	12	15	36.6
70S	2850	4480	106	26	12	80	157	243	90	335	308	283	70	75	80	12	15	37.9
71S,80S	2500	3590	132	36	14	103	178	285	111	380	354	328	70	75	110	12	15	59.3
82S	2500	3890	107	35	15	98	173	280	111	370	350	320	70	75	110	12	11	59.3
55S	2160	3330	108	42	15	110	192	316	129	400	370	340	90	100	130	12	10.5	94.8
86S,95S	2160	3330	162	47	14	126	208	332	129	445	420	392	90	100	130	12	15	94.8
102S,115S	1880	2880	185	52	16	143	242	387	150	514	486	458	105	120	150	16	17	147
121S,135S	1620	2500	216	66	18	168	285	455	175	593	561	529	120	135	170	16	17	230
141S,165S	1370	2150	254	75	23	199	331	521	196	690	650	610	140	160	205	16	22	358
171S,195S	1160	1840	283	82	25	222	349	572	229	808	767	726	170	190	245	16	26	567
201S,235S	980	1540	331	100	28	258	408	675	272	956	908	858	200	230	290	16	32	950
241S,275S	1340	1340	388	116	32	302	488	823	340	1110	1051	992	280	330	330	16	35	1561
280S,285S	1170	1170	476	116	34	358	605	957	358	1262	1195	1128	310	355	355	16	35	2437
310S,320S	1080	1080	520	131	40	400	680	1147	475	1386	1315	1244	330	330	330	24	38	3347
360S	1080	1080	520	131	40	400	680	1147	475	1386	1315	1244	330	380	380	24	38	3347

#### VULKAN DIA PHRAGMS DIMENSIONAL CHARTS

SIZE	O.D. Outer Dia	I.D. Inner Dia	OUTER HOLES			INNER HOLES		
			No. of Hole	Hole Dia	P.C.D.	No. of Holes	Hole Dia	P.C.D.
EZ-51	215	84	12	9	190	12	9	100
EZ-65	235	96	12	9	219	12	9	118
EZ-70	259	109	12	9	242	12	11	130
EZ-80	282	109	12	11	255	12	11	134
EZ-82	287	121	12	11	266	8	13	145
EZ-85	320	146	12	11	301	12	13	170
EZ-89	340	143	12	11	315	12	16	170
EZ-101	394	172	12	13	367	12	16	200
ALU-370	400	170	12	10	380	6	16	196
Vulkan 3226568								
3227013	466	190	8	13	440	10	13	228
3226415								

NOTE : DIMENSIONS ARE IN MM AND APPROXIMATE

Unique Diaphragm Couplings use highly flexible Diaphragms. These consist of Rubber reinforced with Nylon Chords. Further at inner and outer bolting PCD Steel ring reinforcements are used. Torque ratings are determined after extensive tests and have large service factor against rupture. Rupture torque is typically 6 to 10 times rated torque.